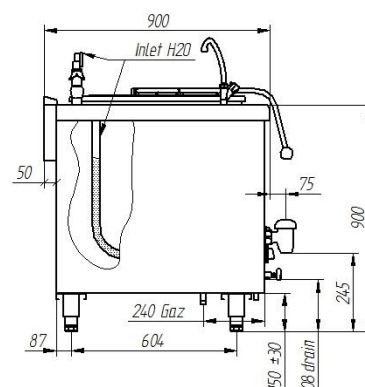
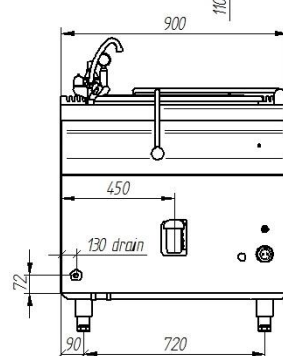
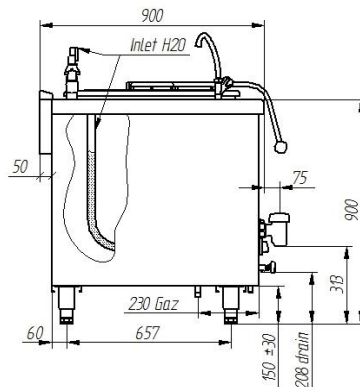
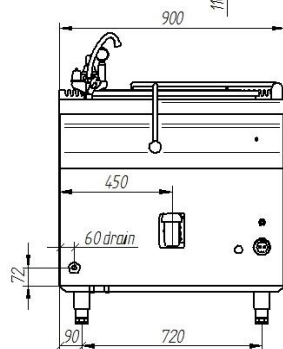
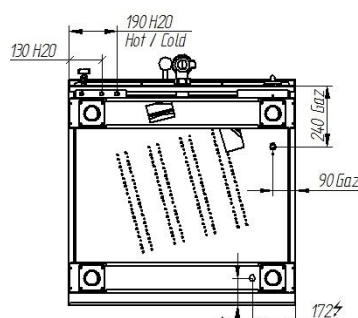
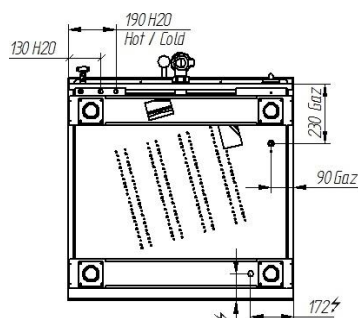

Model:	900.BGK-150	900.BGK-200	
Dimensions	900x900x900 [mm]		
Power rating	21 kW		
	18056 kcal/h		
Working capacity	150 dm <sup>3</sup>	200 dm <sup>3</sup>	
Drain valve	1 1/2"		
Rated voltage, type of current	230V ~		
Max. working pressure	0.5 bar		
Water connection	G 3/8		
Gas connection	R1/2		
Distance between drain valve and ground	313	245	
Gas consumption	E G20 [20mbar]	m <sup>3</sup> /h	2.2
	Lw G27 [20mbar]	m <sup>3</sup> /h	2.75
	3B/P G30 [37mbar]	kg/h	1.6

**Description:**

Gas boiling pans are made of high-grade stainless steels. Working plate made of AISI 304 stainless steel with thickness  $\neq 1.5$ mm, tank bottom made of polished AISI 316L stainless steel. The device is equipped with pilot burner with flame safety device. Indirect heating system prevents burning of foods being prepared. Large drain valve allows for fast pouring of soups to other vessels. The device is fitted with safety valve.

**900.BGK-150****900.BGK-200**

The picture is for reference only; final product may be slightly different from the presented example.