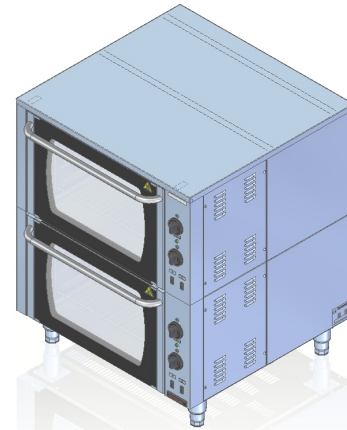

Model:	000.PE-2T	900x850x1110 [mm]
---------------	------------------	-------------------

Electric convection oven

	Power rating	14 kW
	Temperature range	50°–250°C
Chamber	Chamber dimensions	535x650x360 mm
	GN	6 x GN2/1
	Number of chambers	2
Rated voltage, type of current		400V 3N~ 50Hz
Chamber lighting		YES

**Description:**

Electric convection oven with air flow is made of high-grade stainless steels. Working chamber made of AISI 304 stainless steel (mirror layer). Rounded radii in chamber. Each chamber is fitted with two heating elements with two fans which ensure uniform temperature distribution. In total, six levels for containers GN2/1. Long-life, fast heating elements. Bar grate included. Glass door for viewing of products being processed. Removable guides.

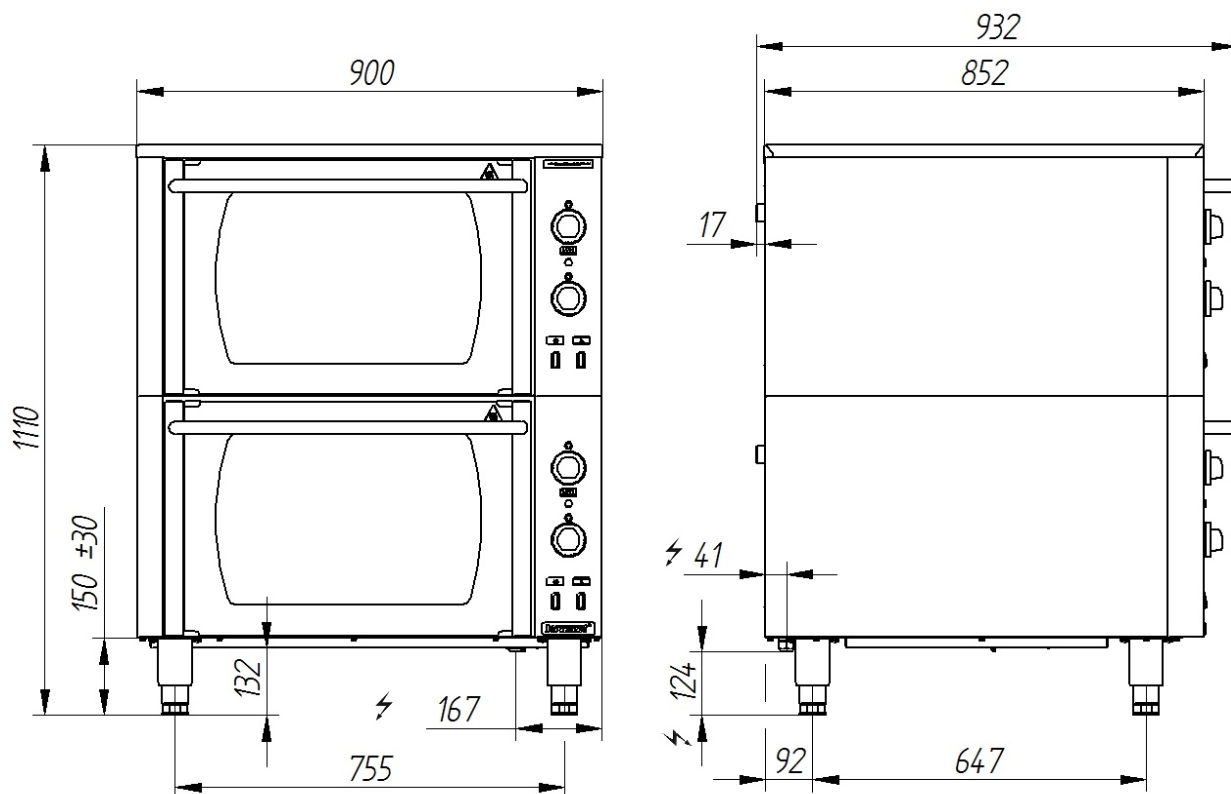
000.PE-2T

The picture is for reference only; final product may be slightly different from the presented example.