

Model:	700.PTG-03	800x700x900 [mm]		
Power rating		10 kW		
		8598 kcal/h		
Capacity		50 dm ³		
Working area		0.3 m ²		
Bowl dimensions		400x700x180 mm		
Water connection		G3/8		
Gas connection		R1/2		
Gas consumption	E G20 [20mbar]	m ³ /h	1.1	
	Lw G27 [20mbar]	m ³ /h	1.25	
	3B/P G30 [37mbar]	kg/h	0.82	

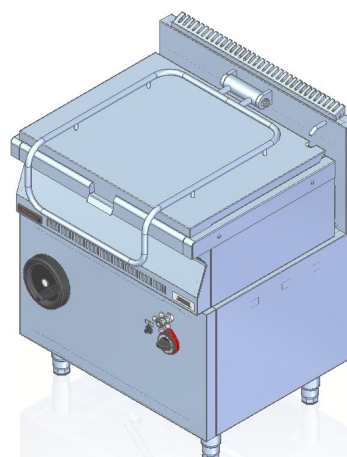

Description:

Electric pans are made of high-grade stainless steels. Working plate made of AISI 304 stainless steel with thickness ≠ 1.5mm. Bowl bottom ensures uniform temperature distribution. Pan with manual bowl-tilting. Water supply spout.

700.PTG-03

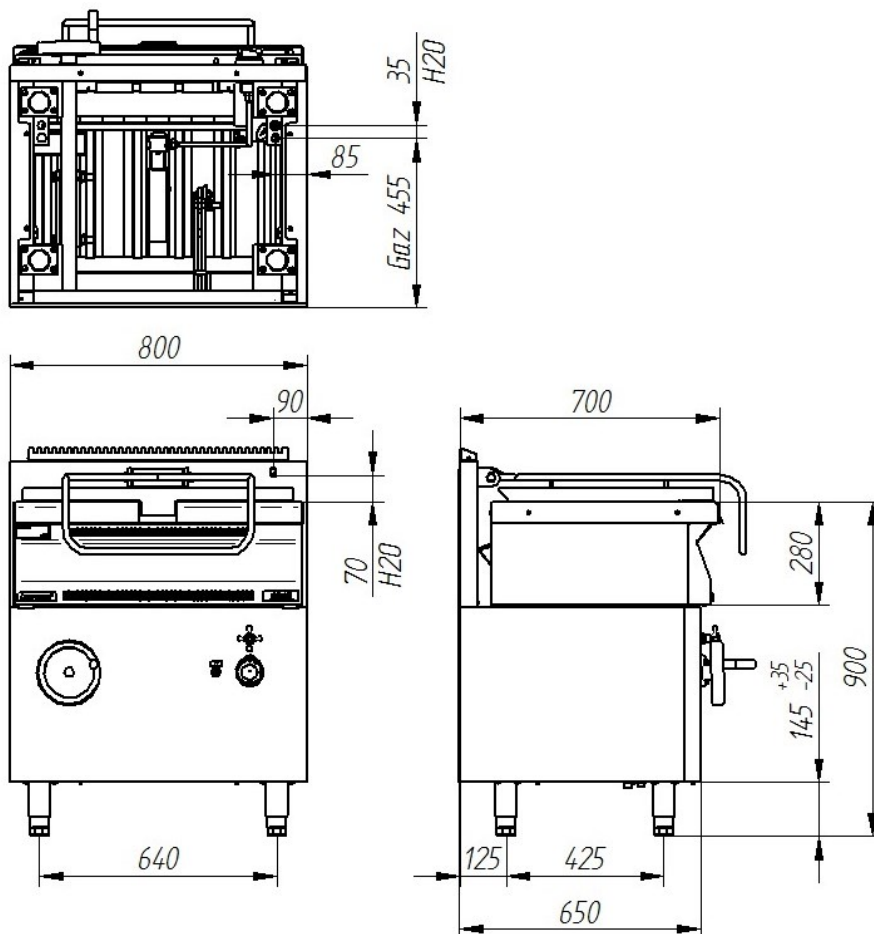

The picture is for reference only; final product may be slightly different from the presented example.

60 LAT
NA RYNKU

Tradition and experience